

A ware washing machine with show doors makes it possible to view the inside of the machine during a wash cycle. This kit has the necessary hardware to fit the show doors to a machine.



A machine with two show doors (left) and a machine with three show doors (right)*.

* With three show doors, only the two opposing doors are operational. The middle door remains static.

Read all the instructions first and verify you have all the parts needed before starting your conversion.
If you have any questions, please call 1-800-922-2178.

REMOVING ORIGINAL DOORS

NOTE: Keep all hardware that is removed; some parts will be needed for reassembly.

Raise the lever arm to decrease the tension in both springs,

After raising the lever arm, disconnect links from doors. The lever arm may now rotate behind the machine.

Remove hardware connecting door to link. The door may now be removed by sliding it up from the guides.

PREPARING DOORS FOR ASSEMBLY

DOOR HARDWARE: Remove protective film from doors. Attach hardware sourced from metal door to show door. See Figure 1 for reference. For the moving doors, attach door stop (P/N 086-6701) through center hole door using a bolt (P/N 098-1434) with a washer (P/N 098-2404). This will be placed on the inside of the door. Using the same bolt on the outside of the door, attach the door link bushing, then the spacer (P/N 084-6703), and lastly the door link. Secure this assembly with a cap nut (P/N 098-2405) and washer (P/N 098-2404). Place two 1/4 X 5/8" bolts in unused holes. To prepare static middle door, place three 1/4 X 5/8 bolts in the unused middle holes. CAUTION: Do not overtighten-this may cause the door to crack.

NOTE: Door stop and door link spacer are not included in the kit. It may be reused from the original door.

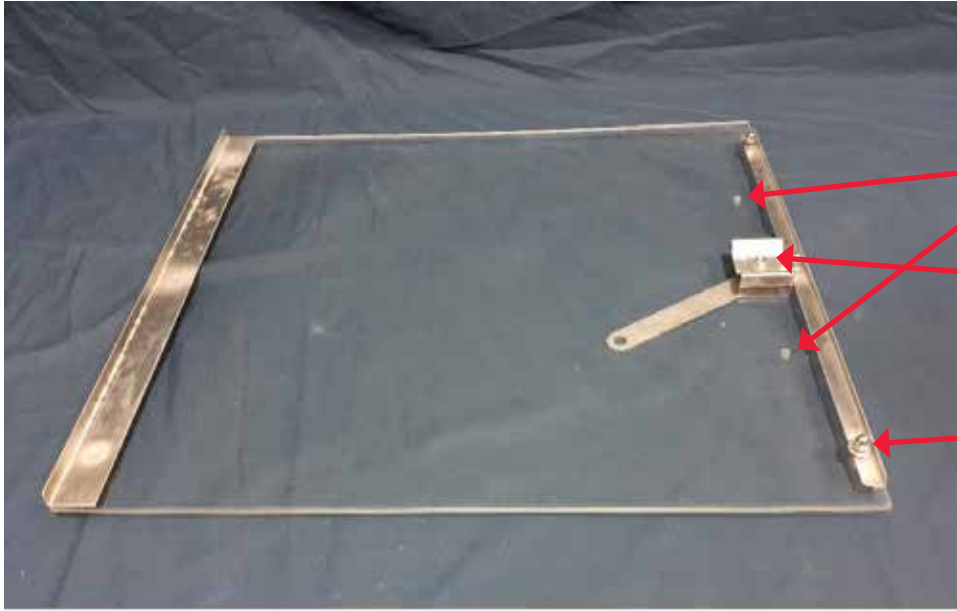

Place 1/4" bolts with washers in unused holes to seal door.

Attach door stop to inside of door as shown.

Attach lower brace to door with cap nuts. The studs should face the inside of the door.

ORDER OF ASSEMBLY

INSTALLING SHOW DOOR: Replace the original door with show door, placing it over the door opening.

LOWER BRACE: After door is in place, attach lower brace with the studs facing the inside of the machine with washer (P/N 098-2404) and 1/4" lock nut (P/N 098-2507). See Figure 1 to see this orientation.

DOOR GUIDES FOR STATIC DOOR: Install door guides on the open door. Leave bolts loose. Put the door on, centering it over the opening. Slide the guides against the door and tighten bolts.

DOOR LINKS: Connect links to lever arm. See Fig. 3

SECONDARY SPRING EXTENSIONS: Use Figure 3 as a reference for this step. Replace the secondary extension ("C" hook: 4" for 3D, 5" for 3DS and L3DWS, 7" for ES models) with the two extensions (P/N 086-6703) included in the kit. They should be installed inline from the bottom of the spring and through the eyebolt. This is necessary because the default spring tension was set for the original doors, and the default spring tension would cause the doors to snap open.

After connecting the spring extensions, pull the eyebolt down through the hole in the frame located directly under each spring assembly. The ADS tool (P/N 088-1052) simplifies the pulling down and threading of the eyebolt. A 5/16 nut is used to secure the eyebolt.

CAUTION: Lubricate the threads and DO NOT turn the nut under tension --- it can cause locking of the threads.

ADJUST DOORS: The lever arm should hold the door in the open position as well as in the closed position. If the doors hang down from full-up position, you need more of the eyebolt threads extending below the adjusting nut. If the doors won't stay down, you need less of the eyebolt threads below the nut.

UNEVEN DOORS: the bent tubing of the lever arm is the cause of alignment. The lever arm must be bent further to even out the alignment. Hold one side down while lifting on the other until the doors are even.

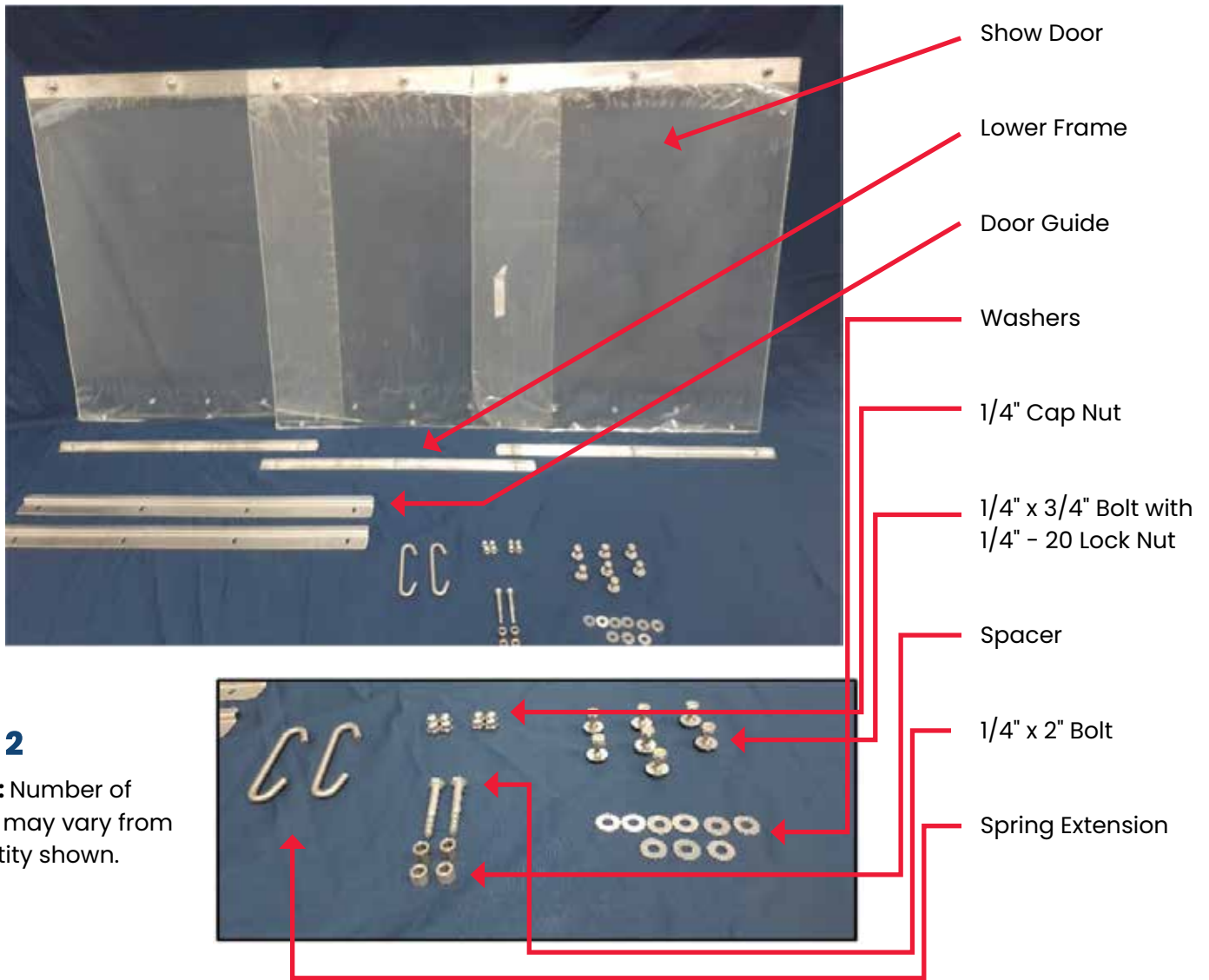

FIG. 2

NOTE: Number of parts may vary from quantity shown.

KIT CONTENTS

Part #	Item Description	Qty
085-6258	Show Door Upper Brace Weldment	3
085-6259	Show Door Lower Brace Weldment	3
093-2011	Door, Show "Lexan" Side 3 Door Up (3 Needed)	3
098-1425	Bolt, 1/4-20 X 5/8" HH	12
098-1434	Bolt, 1/4-20 X 2" HH	2
098-2404	Washer, 1/4 SS Flat (Large)	36
098-2405	Nut, Cap, 1/4 -20 w/ Nylon Insert	12
098-2507	Nut, Lock, 1/4-20 w/ Nylon Insert	17
087-6114	Door Guides	2
084-6703	Spacer, Bushing, 3D, 3DS, "L" (2&3 Door Up)	2
086-6703	Spring Extension, Secondary	4

FOR REFERENCE:

Lever Arm Linkage Assembly

Ref. No.	Part No.	No. Req.	Description
1	085-6701	2	Spring Extension, Weldment
2	098-4002	2	Bushing, Bronze
3	098-1514	2	Bolt 5/16-18 x 1 1/2" HH SS
4	098-2505	2	Nut, Cap, 5/16-18
5	085-6703	1	Bracket, Lever Arm Support LH
N/S	085-6707	1	Bracket, Lever Arm Support RH
6	098-1423	4	Bolt, 1/4-20 x 1/2" HH SS
7	098-2404	10	Washer, 1/4" SS
8	098-2507	4	Nut, Lock, 1/4-20 SS
9	085-6726	1	Lever Arm (universal inline)
10	098-1431	2	Bolt, 1/4-20 x 1 3/8" HH SS
12	084-6703	4	Bushing, Dowel SS
14	098-1432	2	Bolt, 1/4-20 x 1 3/4" HH SS
17	098-2405	4	Nut, Cap, 1/4-20 SS
18	098-3003	2	Spring, Door
20	098-1581	2	Bolt, Eye, 5/16-18 x 6"
21	098-2502	2	Nut, 5/16-18 HH SS
22	099-1018	2	Cap, Lever Arm (black plastic)
23	086-6623	1	Bracket, Lever Arm Cut-Off (L Bracket)
N/S	098-2503	2	Washer, 5/16" Copper
19	086-6703	2	¹ Spring Extension, Secondary, "C" Shaped - 4" OA
19	086-6737	2	² Spring Extension, Secondary, "C" Shaped - 5" OA
19	086-6738	2	³ Spring Extension, Secondary, "C" Shaped - 7" OA

¹CAUTION USE ONLY FOR AF-3D MACHINES

²CAUTION USE ONLY FOR AF-3D-S, L3DWS

³CAUTION USE ONLY FOR AF-ES MACHINES

FIG. 3

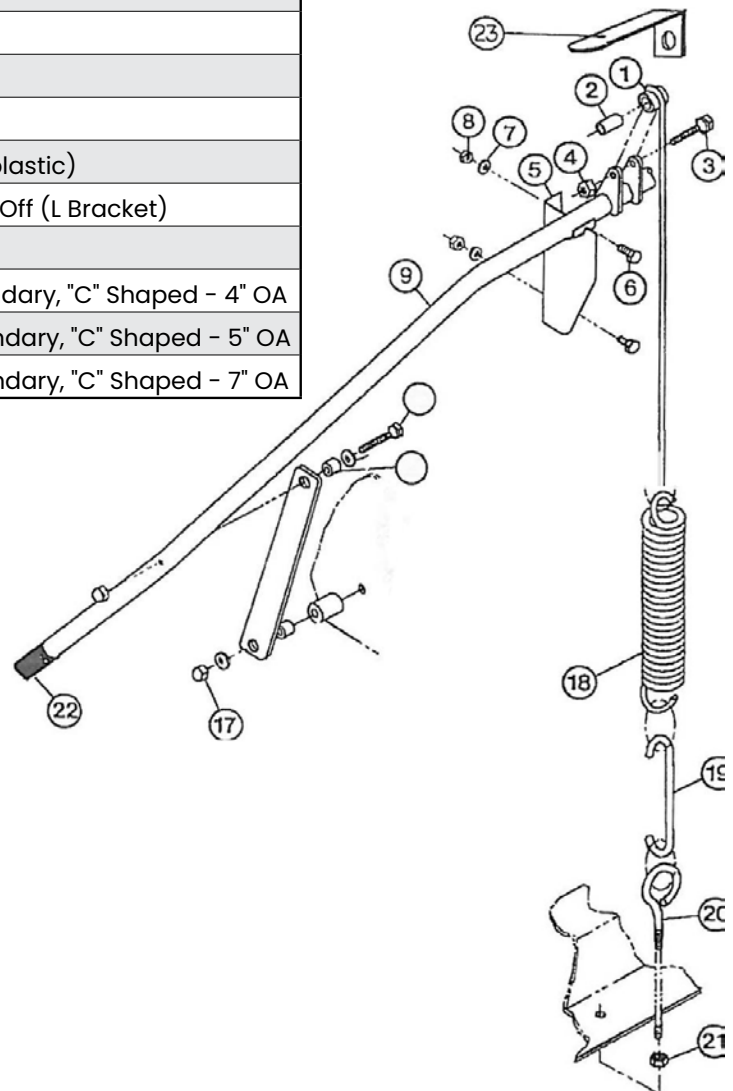

DOOR SPRINGS (FOR REFERENCE ONLY): Use Figure 3 as a reference for this step. Place the springs (two springs for Inline) on the extension hooks. Replace the secondary extension (“C” hook: 4” for 3D, 5” for 3DS and L3DWS, 7” for ES models) with the two extensions (P/N 086-6703) included in the kit. They should be installed inline from the bottom of the spring and through the eyebolt. This is necessary because the default spring tension was set for the original doors, and the default spring tension would cause the doors to snap open.

After connecting the spring extensions, pull the eyebolt down through the hole in the frame located directly under each spring assembly. The ADS tool (P/N 088-1052) simplifies the pulling down and threading of the eyebolt. A 5/16 nut is used to secure the eyebolt.

CAUTION: Lubricate the threads and DO NOT turn the nut under tension—it can cause locking of the threads.

DOOR GUIDES FOR MOVING DOORS (FOR REFERENCE ONLY): Install door guides on the open door. Leave bolts loose. Put the door on, but do not attach to the lever arm linkage yet. The door should be centered over the door opening and laying flat across the top of the machine. Tighten the rear guide. Now, slide the forward door guide next to the door with 1/8” free play and tighten the four bolts securing the door guide. NOTE: both doors should now move up and down freely without binding. The doors and guides must be parallel to each other. There should be a 1/16” to 1/8” play between the door and the two guides.

FOR REFERENCE: Hardware Placement Diagram

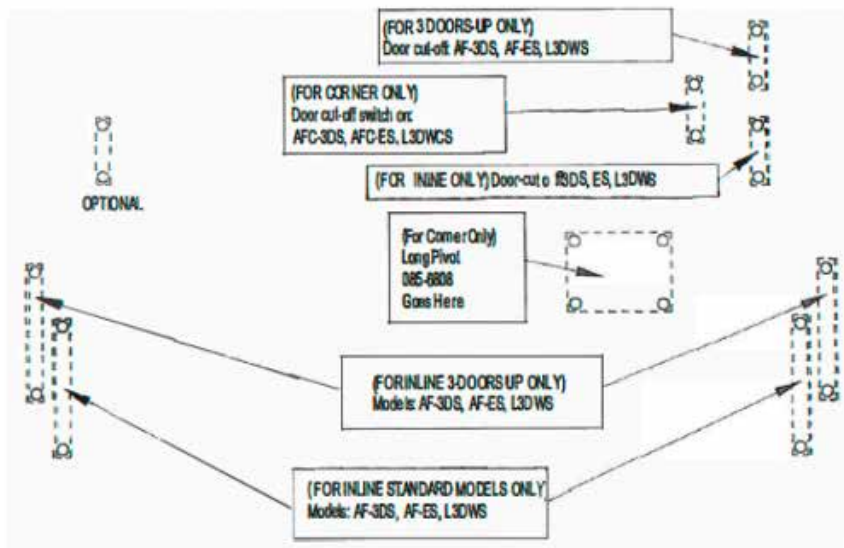

FIG. 4

BACK PANEL OF HOOD FOR AF-3DS, AF-ES, L3DWS

WARNING!

This product is manufactured solely for **commercial** use.

It is not to be used in residential installations of any kind.

Doing so will immediately void all warranties.

American Dish Service assumes no liability for such
unintended uses.

**FOR PARTS & SERVICE
MANUALS GO TO**

www.americandish.com

